

TYPE 95 802 B, C

The signal device meets the following regulations:

ICAO Annex 14, Volume I, 4th edition 2004

(Photometric requirements)

FAA Specification AC 150/5345-46C

(Resistance against environmental effects)

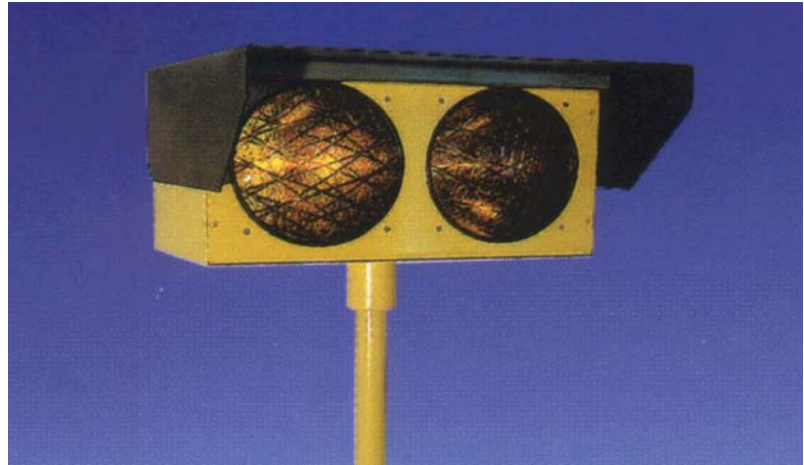

Basic Information

The basic section of this **signal device** consists of a housing made of aluminium sheet on the front wall of which two red (Variant B) or yellow (Variant C) coloured diffusers are located. A tube is riveted on the rear wall into which a plate of the flasher, along with the signal device control electronics, is inserted from the above ensuring switching over the bulbs in alternating mode.

In the middle part of the housing, a guide and hangings are riveted on which reflectors with bulb sockets are fixed. The signal device cover fixed with two closures to the rear wall functions simultaneously as a shield protecting diffusers against sunrays, rainwater, and snow.

The **supply cable** for bulbs goes through a fixing pipe and terminates with the standard plug outside the signal device. Powder coating in the "aerial yellow" tint protects the signal device housing. The signal device design makes it resistant against static and dynamic effects of the ambient environment it is exposed to during the operation.

Technical Diagram

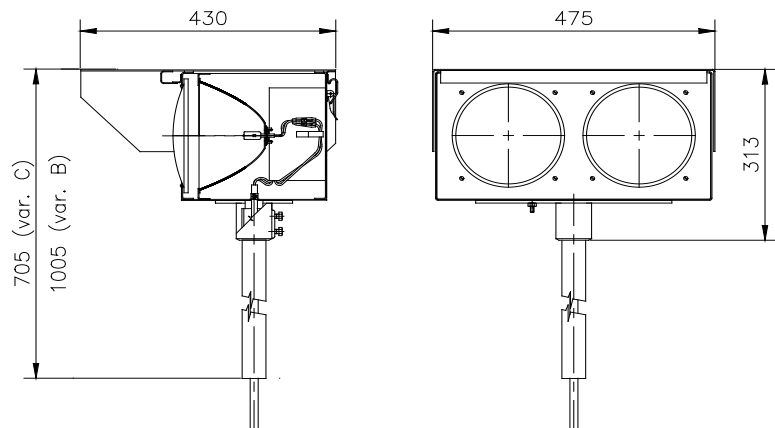

Use

The airport **parking signal device** is used for luminous indication that access to the airport runway is prohibited; two **variants** are available for this kind of indication:

- 95 802 B as the signal device in the parking position while waiting for communication
- 95 802 C as the runway protection signal device with low luminosity, model A (ICAO Annex 14, Volume I, 3rd edition 1999).

Installation

The parking signal device may be installed directly into the ground on a tilting needle, or fixed to the cover.

Installation example:

- 1 – Parking signal device
- 2 – Breakable coupling
- 3 – Concrete (asphalt) protective circle
- 4 – Tilting needle
- 5 – Concrete for anchoring the needle

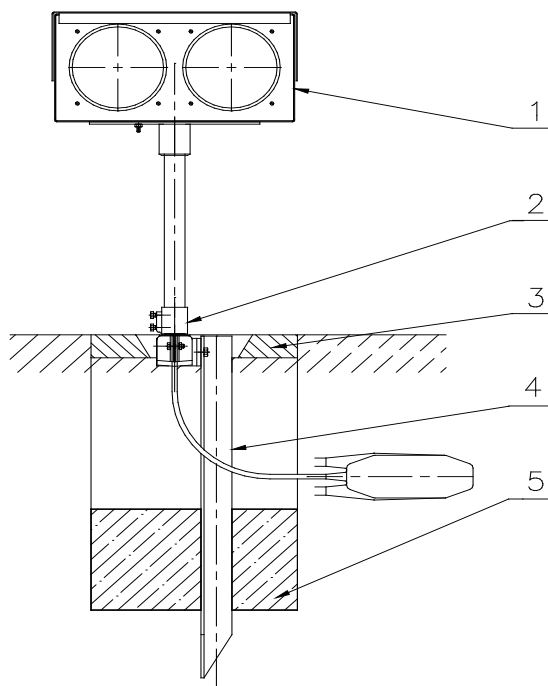

Basic Technical Data

Mechanical parameters:

Dimensions (WxLxH): 475x313x430 mm (shielded)
Mass: 10 kg

Electrical parameters:

Variant B / Variant C Input: 45 W / 100 W
Current: 6.6 A
Insulation resistance: Min. 50 MΩ
Protection level: IP54
Luminous source used: Airport halide bulb
45 W (100 W) / 6.6 A, Pk30d

Other parameters:

Operation temperature: -55°C up to +55°C

Contact

ELTODO EG, a.s.
Novodvorská 1010/14
142 01 Praha 4, Czech Republic
Phone: +420 261 346 828
Fax: +420 261 346 803
E-mail: eltodo@eltodo.cz
<http://www.eltodo.cz>